

N <sup>o</sup> of Course	Course up the Ohio &c	Distance
1	N. 27 E 96	
2	N. 14 E 16	
3	N. 3 E 20	
4	N. 22 E 112	
5	N. 29 E 116	
6	N. 37 E 60	
7	N. 43 E 60	
8	N. 54 E 54	
9	N. 59 E 48	
10	N. 66 E 52	
11	N. 71 E 115	
12	N. 67 E 55	
13	N. 73 E 112	
14	N. 83 E 29	
15	N. 88 E 47	
16	S. 85 E 51	
17	S. 78 E 39	
18	S. 74 E 93	
Total Dist <sup>l</sup> 965		

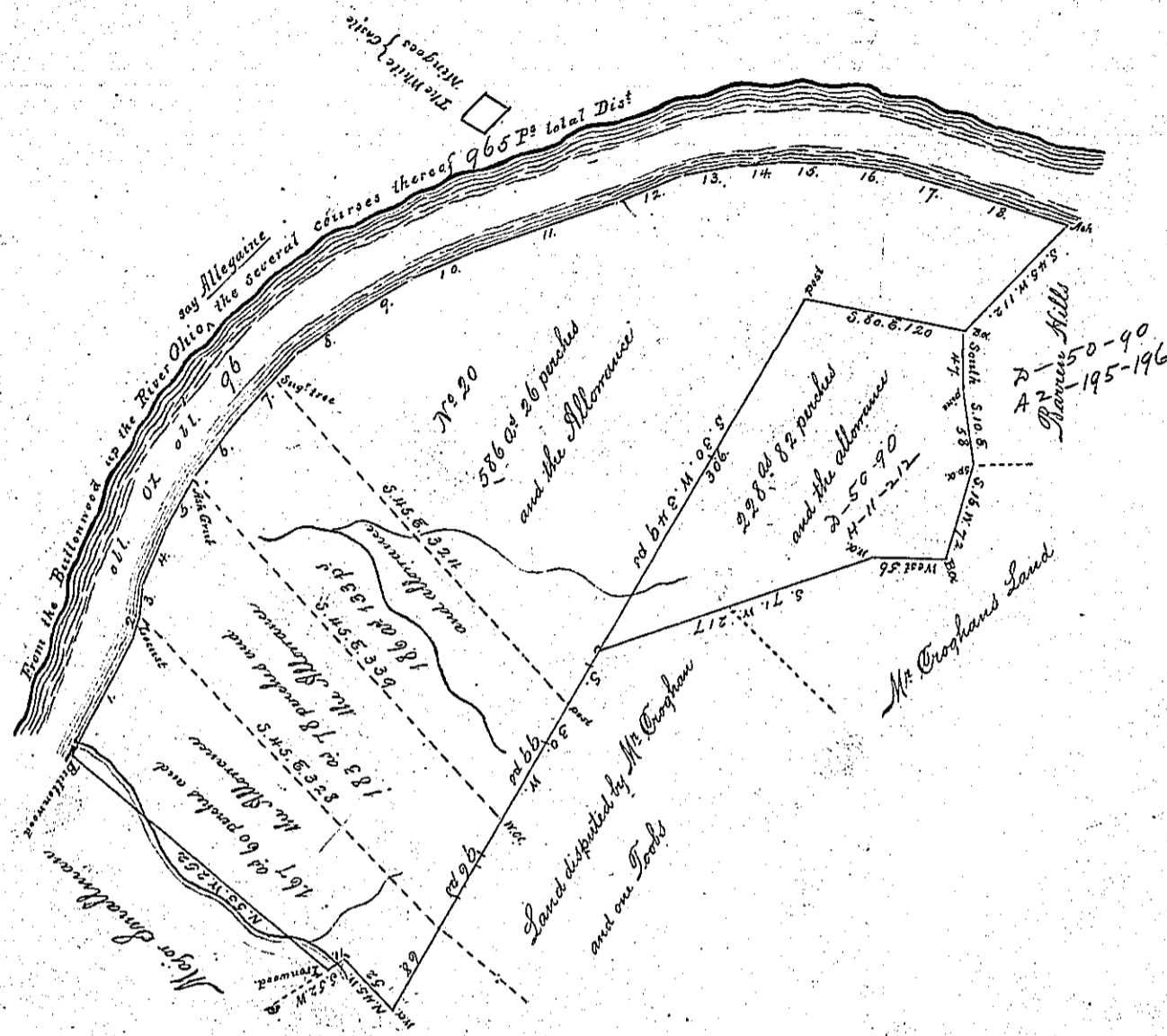

In pursuance of an Order N<sup>o</sup> 20 dated the first day of April 1769 Survey'd for Mr. George Croghan the above Described tracts of Land each containing the Quantity therein Inserted with the usual Allowance. Otherwise Containing in the whole Thirteen Hundred & fifty two Acres and 39 perches with an Allowance proportioned to 6 per cent. Situate on the River Ohio from the mouth of the two mile Run up to the Narrows Including several of his Improvements &c Surveyed the 26 & 27<sup>th</sup> of June 1769.

To John Lukens Esq<sup>r</sup>  
S. Gen<sup>l</sup>

p Robert M<sup>o</sup> Crea [S]  
D.S.

IN TESTIMONY that the above is a copy of the original remaining on file in the Department of Internal Affairs of Pennsylvania, made conformably to an Act of Assembly approved the 16th day of February, 1833, I have hereunto set my Hand and caused the Seal of said Department to be affixed at Harrisburg, this

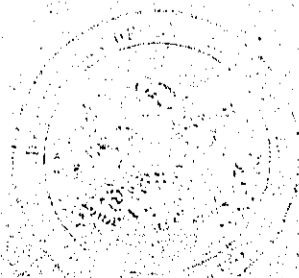

third day of November 1896

James W. Patton  
Secretary of Internal Affairs